

INTERNAL
FLANGE

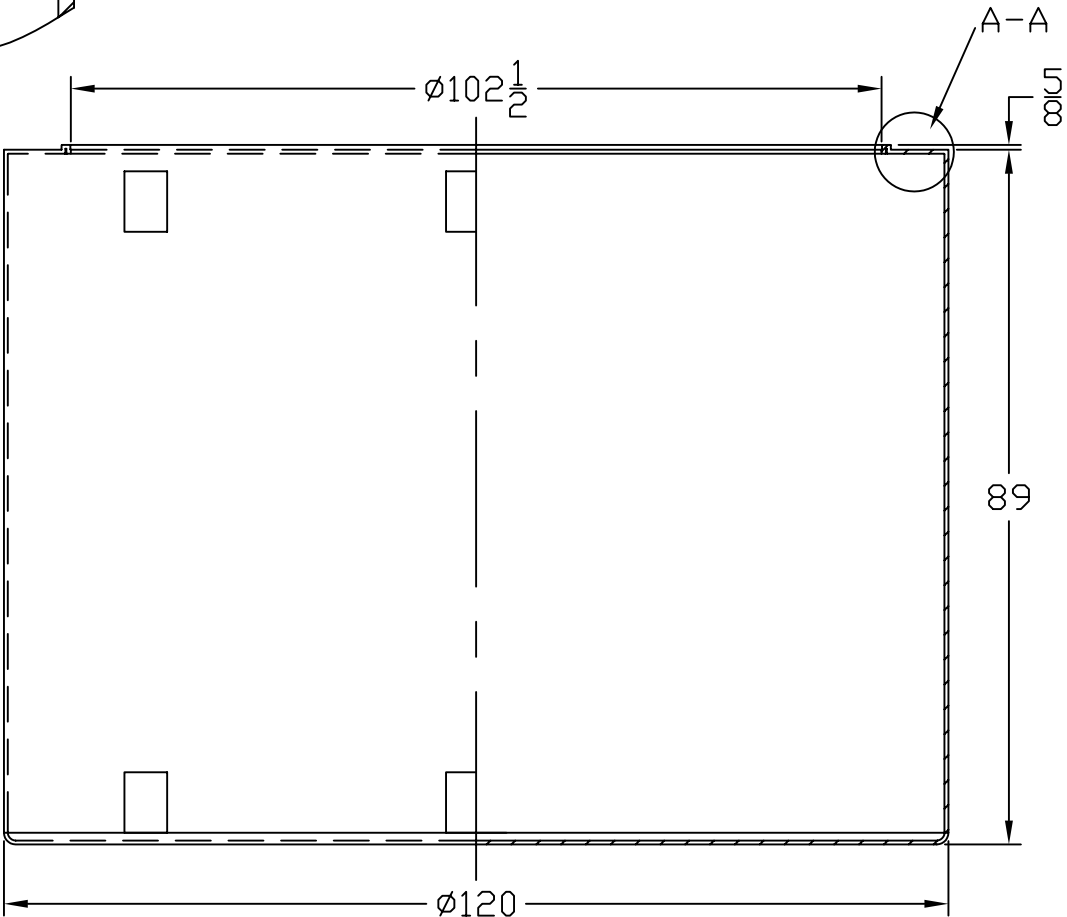

Rev. 2	Date 04/12/01	File Name TK4250-A
CHEM-TAINER		
361 Neptune Ave. (631) 661-8300	Industries Inc. W.Babylon, NY 11704 Fax: (631) 661-8209	
	Date 02/29/00	Mold Location TN
	Drawn By: IIA	Cust. Rep.

NOMINAL FLANGE IS 2 INCHES

THIS DRAWING & DESIGN IS
THE PROPERTY OF CHEM-TAINER INDUSTRIES INC.
IT MAY NOT BE USED FOR ANY PURPOSE
OTHER THAN BY THE OWNER. CHEM-TAINER DOES NOT
AUTHORIZE THE REPRODUCTION OR CONVEYANCE
OF ANY INFORMATION CONTAINED HEREIN.

ALL DIMENSIONS SHOWN ARE OUTSIDE PART DIMENSIONS IN INCHES,
AND VARY BY THE STANDARD ROTATIONAL MOLDING TOLERANCE OF $\pm 2\%$.

Part #	Dwg. #
TC42500A	TC42500A
4250 GAL. CYLINDRICAL CONTAINMENT BASIN	